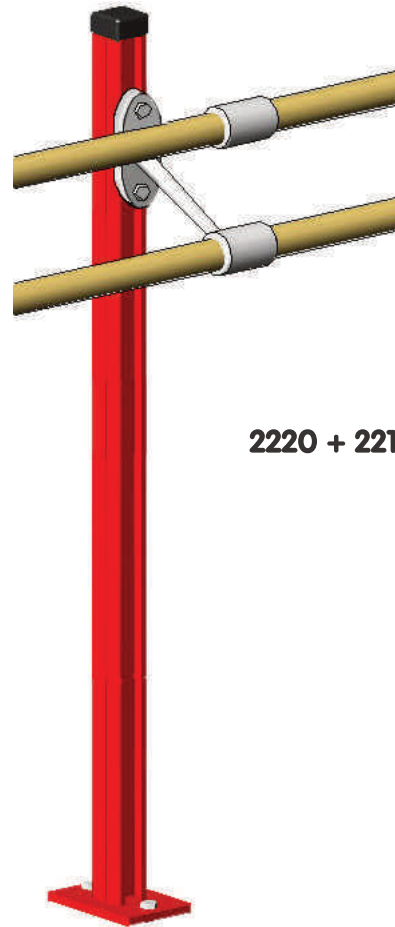

**BRACKET ADJUSTABLE SUPPORT FRAME
FOR BALLET BARS M'2006****2220 + 2216A
2220 + 2217A****KEEP THIS
DOCUMENT****2220 + 2216A****2220 + 2217A****Warning:**

This equipment should be installed by a qualified individual.
The apparatus should only be used under the supervision of a qualified individual.
Using this equipment for purposes other than those originally intended is not allowed.

Compliance:

This equipment complies with the requirements of the European standard EN 913 "Gymnastic equipment - General safety requirements and test methods".

Recommendations:

- As shown in French Standard NF S 52-400 the following are recommended:
- keep these instructions for subsequent reference (inspection, maintenance, etc.).
 - periodically carry out predictive maintenance.
 - depending on how much it is used have the equipment serviced yearly or every few years.

Max. overall size:

- Width of floor adjustable support frame plates: 150 mm (5.90 in)
- Distance between bars and wall: 330 mm (12.99 in)

Adjustment range:

- Single bracket from 18 cm to 1.05 m (7.09 in to 41.34 in).
- Double wall bracket: Upper bar from 25 cm to 1.05 m (9.84 to 41.34 in) - Lower bar from 5 cm to 85 cm (1.97 to 33.46 in).

Packaging:

- Wooden bar, $\varnothing 40$ (1.57 in) - Length: 1.60 m (62.99 in) (**Unit Ref.: 2220**) \rightarrow 1 pack (Grouped per quantity)
Unit dimensions: $\varnothing 40 \times 1600$ mm (1.57 x 62.99 in) - Unit volume: 0.026 m³ (0.918 ft³) - Unit weight: 1.5 kg (3.31 lb)
- Adjustable support frame with simple bracket (**Ref.: 2216A**) \rightarrow 1 pack
Dimensions: 1230 x 220 x 180 mm (48.43 x 8.66 x 7.09 in) - Volume: 0.049 m³ (1.730 ft³) - Weight: 9 kg (19.84 lb)
- Adjustable support frame with double bracket (**Ref.: 2217A**) \rightarrow 1 pack
Dimensions: 1230 x 220 x 210 mm (48.43 x 8.66 x 8.27 in) - Volume: 0.057 m³ (2.013 ft³) - Weight: 9 kg (19.84 lb)

Maintenance:

Before each use, check the correct tightening of all attachment elements.

I. Preparing the floor attachments (Fig.: 1):

- 1/ Mark the distances between bracket support frames (7) on the floor: 1500 mm (4.92 ft) at both ends, and 1600 mm (5.25 ft) in the center (intermediate brackets).
- 2/ On the floor, mark the position of attachment elements (2 parallel lines, spaced by 110 mm (0.36 ft)), 100 mm (0.33 ft) apart from the wall, to which the adjustable support frames (7) will be secured.

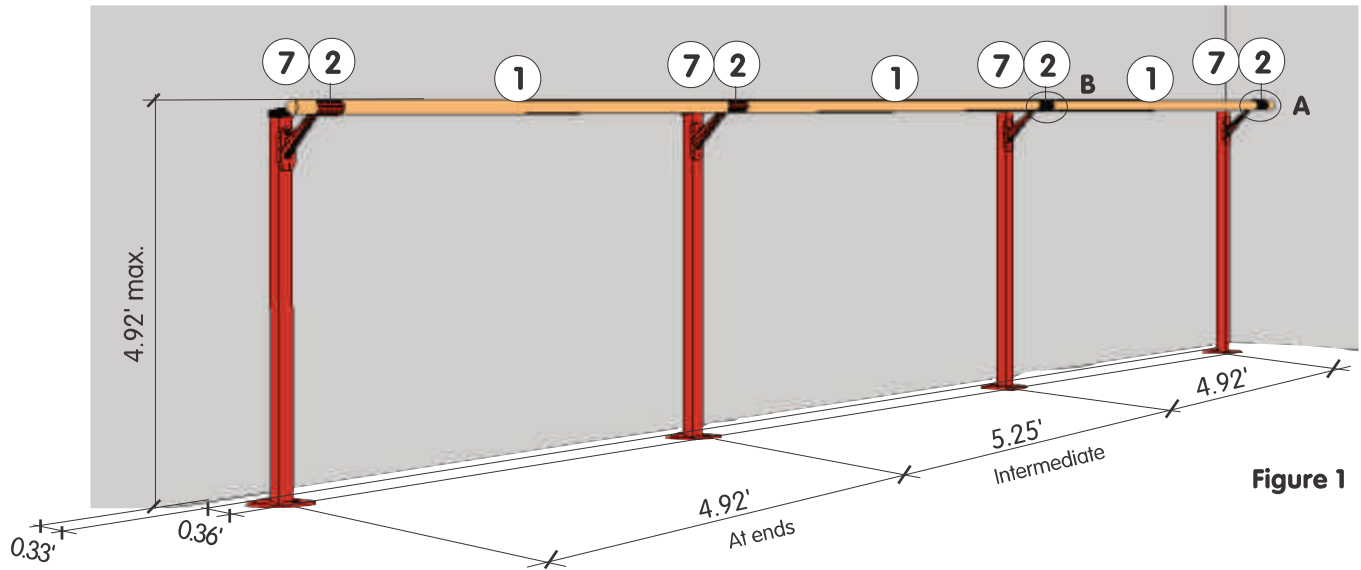

Figure 1

II. Installing the floor attachments (Fig.: 1 & 2) (2 individuals recommended):

- 1/ Drill two $\varnothing 12$ mm (0.47 in), 90 mm (3.54 in) deep holes, spaced by 110 mm (0.36 ft), along the plot of each bracket support frame (2) (see Fig. 7).
- 2/ Vacuum clean the dust.
- 3/ Position one bracket support frame (7) onto the plot.
- 4/ Install 2 washers (9). Hammer the expansion bolts (8) supplied, through both washers (9) and the plate of each bracket support frame (7).
- 5/ Moderately tighten the bolts (8) in order to allow for correct alignment of the bars (1).

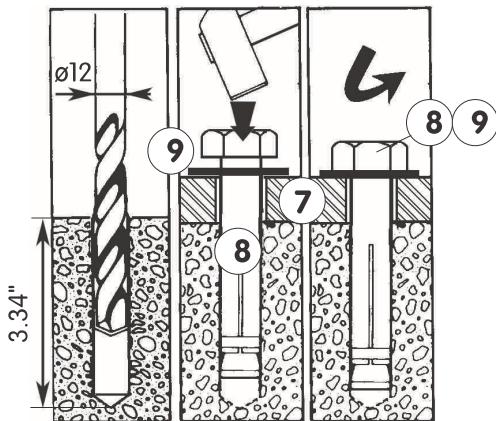

Figure 2

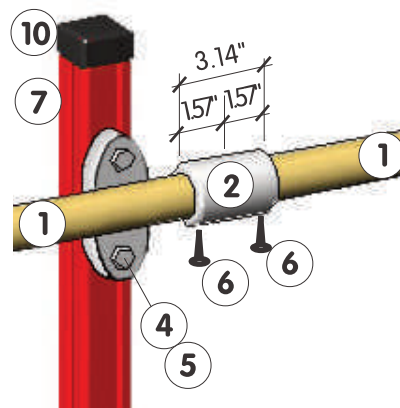

Figure 3 - Intermediate - Detail B

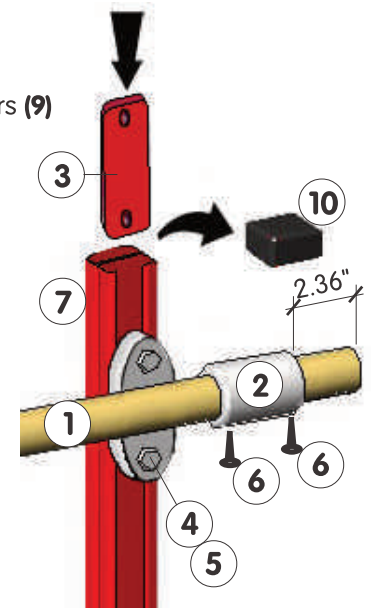

Figure 4 - End - Detail A

III. Installing and securing the ballet bars (Fig.: 1, 3, and 4) (2 individuals recommended):

- 1/ First position one bracket (2) onto a support frame (7), at one end: remove the black plastic cap (10), before inserting a backplate (3), to secure the bracket (2), using 2 washers (5) and 2 screws (4): tighten moderately.
- 2/ Slide one wooden bar (1) through the previously attached bracket (2), and let the end protrude by 60 mm (2.36 in) (Fig. 4).
- 3/ Slide a second bracket (2) at the other end of the wooden bar (1) already in place: insert it by 40 mm (1.57 in) (approx.), i.e. just in the center of the cylindrical section (see Fig. 3).
- 4/ Repeat operation 1/ to install the second bracket (2) and moderately tighten the attachment elements (4) + (5).
- 5/ Pre-install a second wooden bar (1) onto the next bracket (1): insert it by 40 mm (1.57 in) (approx.).
- 6/ Position, then slide the assembly (1)+(2) through the previous bracket (2). Align the supports frames (7) in succession.
- 7/ Repeat operations 5/ and 6/, until the last bracket (2) is in place: slide it over the last wooden bar (1) (the bar end should protrude by 60 mm (2.36 in)), and secure it to the last support frame (7).
- 8/ Check the alignment of the wooden bars (1), then tighten the floor attachment elements (9) to a 23 Nm torque.
- 9/ Adjust the height of the ballet bars (1) as required; then lock all the attachment elements (4) + (5).
- 10/ The wooden bars (1) are very slightly curved. For the assembly to be aligned with the wall (stand up in line), rotate each bar (1) until the convex part points downward (or upward).
- 11/ Secure the wooden bars (1) onto the brackets (2) from below: 1 at each end, and 2 intermediate (7) using the self drilling screws (6) (see Fig. 3 and 4).

Single adjustable bracket

Double adjustable bracket

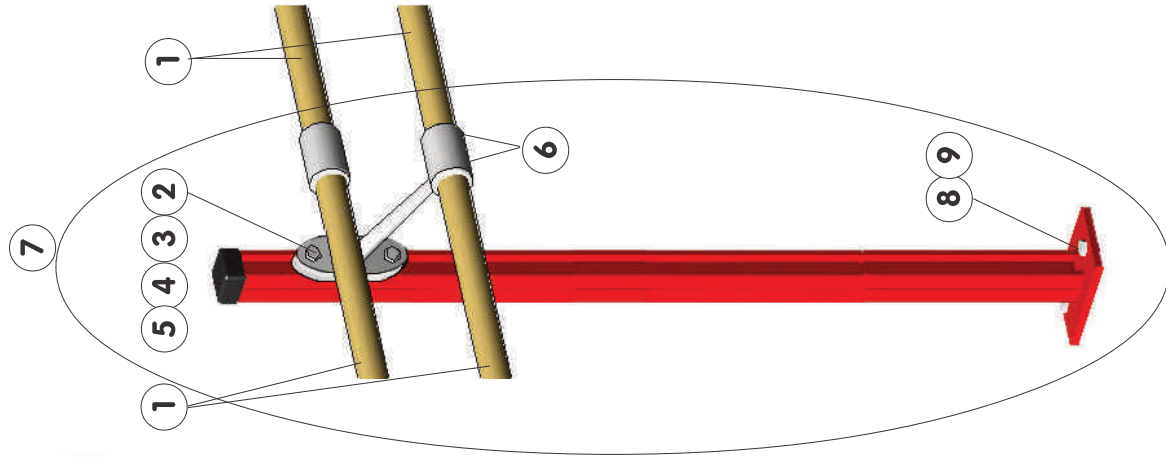
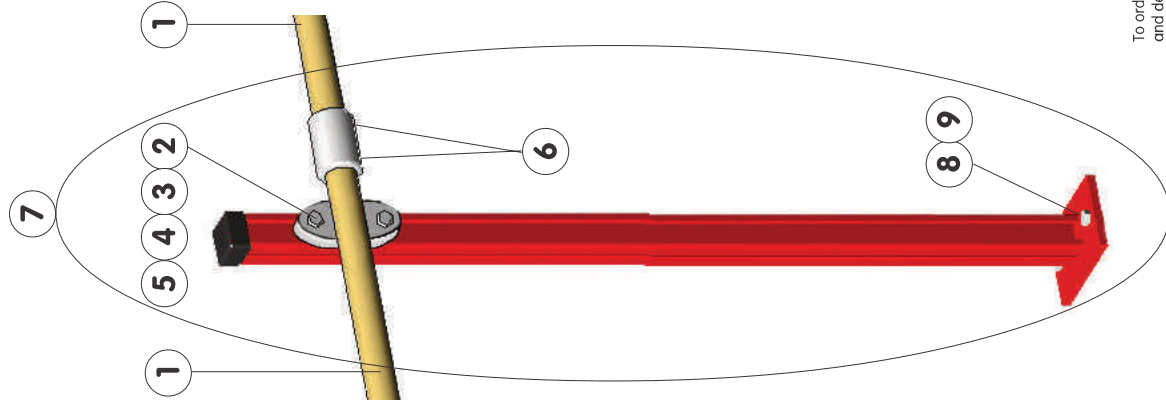
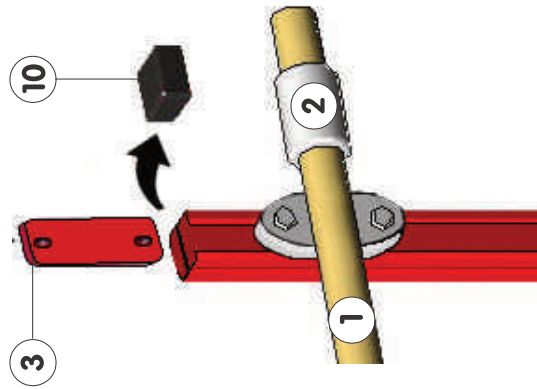

ITEM	QTY	DESCRIPTION	REFERENCE	REMARKS
28	-		-	-
27	-		-	-
26	-		-	-
25	-		-	-
24	-		-	-
23	-		-	-
22	-		-	-
21	-		-	-
20	-		-	-
19	-		-	-
18	-		-	-
17	-		-	-
16	-		-	-
15	-		-	-
14	-		-	-
13	-		-	-
12	-		-	-
11	-		-	-
10	1	Black plastic cap	QEPE5050NO	each
9	2	M12 x 27 flat washer	VRP012270Z	each
8	2	M10 expansion bolt	QCHESPMG08	each
7	1	Double adjustable support frame	2217A	each
7	1	Single adjustable support frame	2216A	each
6	-	Ø4.8x32 self drilling screw	VWZ048032A	each
5	2	M12x20 external tooth lock washer	VREE12200Z	each
4	2	HM12 x 25 screw	VH0012025Z	each
3	1	Attachment backplate	X2216/02	each
2	1	Double bracket	2212A	each
2	1	Single bracket	2210B	each
1	-	Wooden bar, Ø40, 1,60 m long	2220	each

GYMNOVA
 CS 30056 - 45 RUE GASTON DE FLOTTE
 13012 MARSEILLE CEDEX 12 (FRANCE)
 TEL.33.(0)4.91.87.51.20 - FAX.33.(0)4.91.93.86.89
 www.gymnova.com - info@gymnova.com

**BRACKET ADJUSTABLE SUPPORT
 FRAME FOR BALLET BARS M'2006**

To order spare parts, provide the description, part no., and delivery date of the entire apparatus.